



AVA MASTER SERIES

Replacement of electrical box & microswitch

Needed tools:

- T25 (torx) screwdriver with a length of 200mm minimum.
- Small flat screwdriver
- Pliers

1



NOTE! Disconnect all power before starting service!

Remove the six screws from the back of the machine as indicated on the drawing.

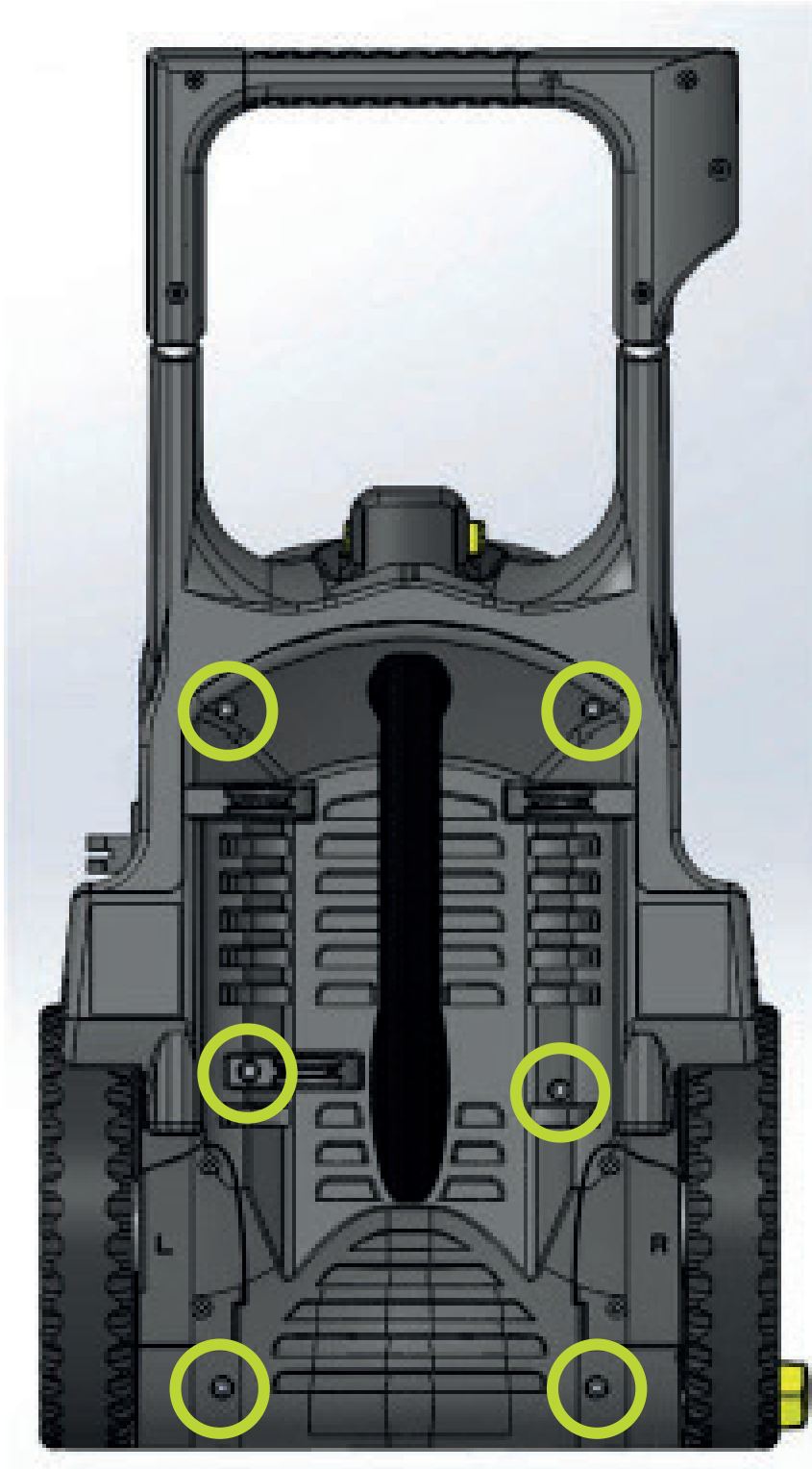

2

Turn off the water filter if you have not already done so. It should now be possible to remove the front cover marked here in blue. The aluminum bracket marked in green Comes off with the front cover.

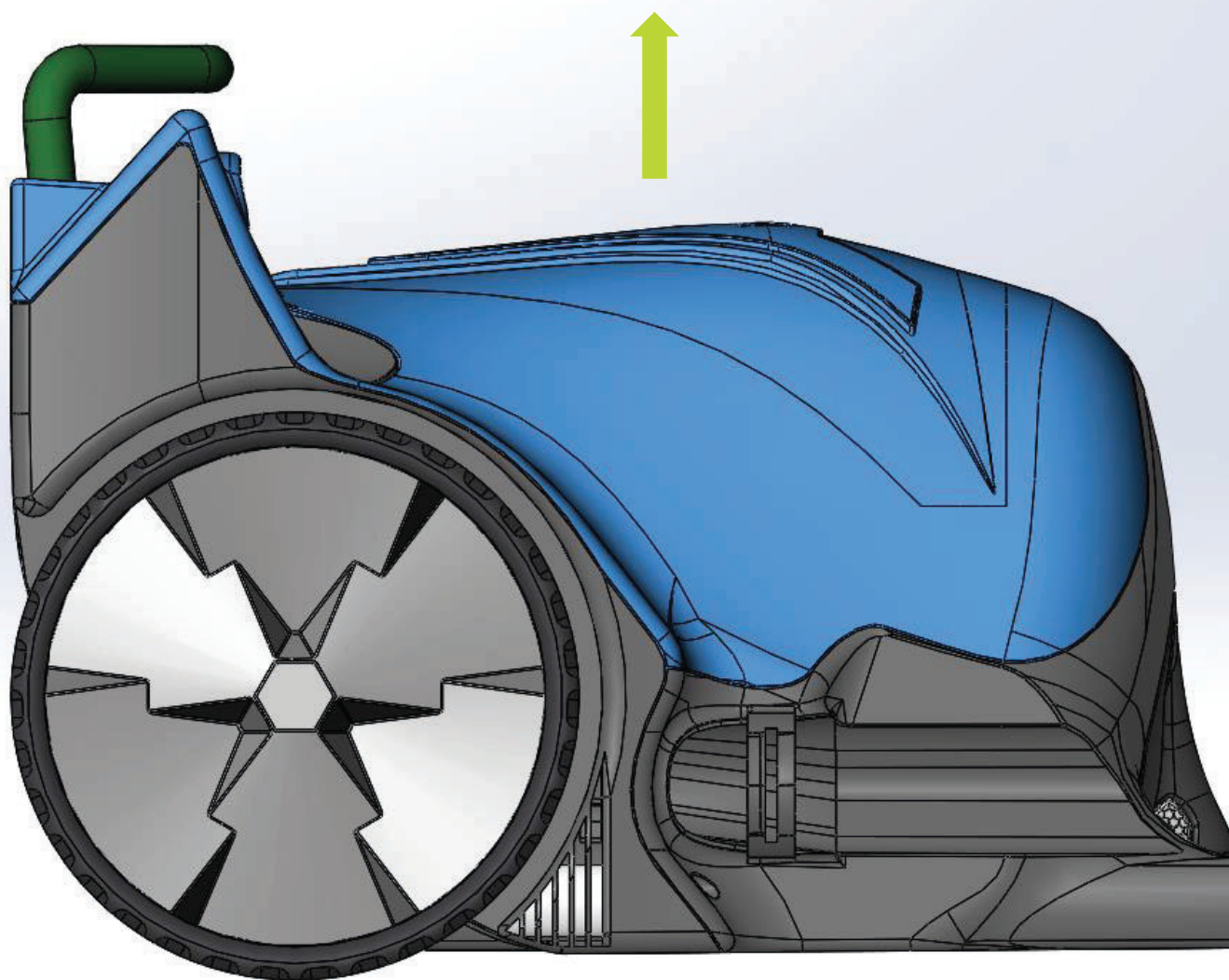

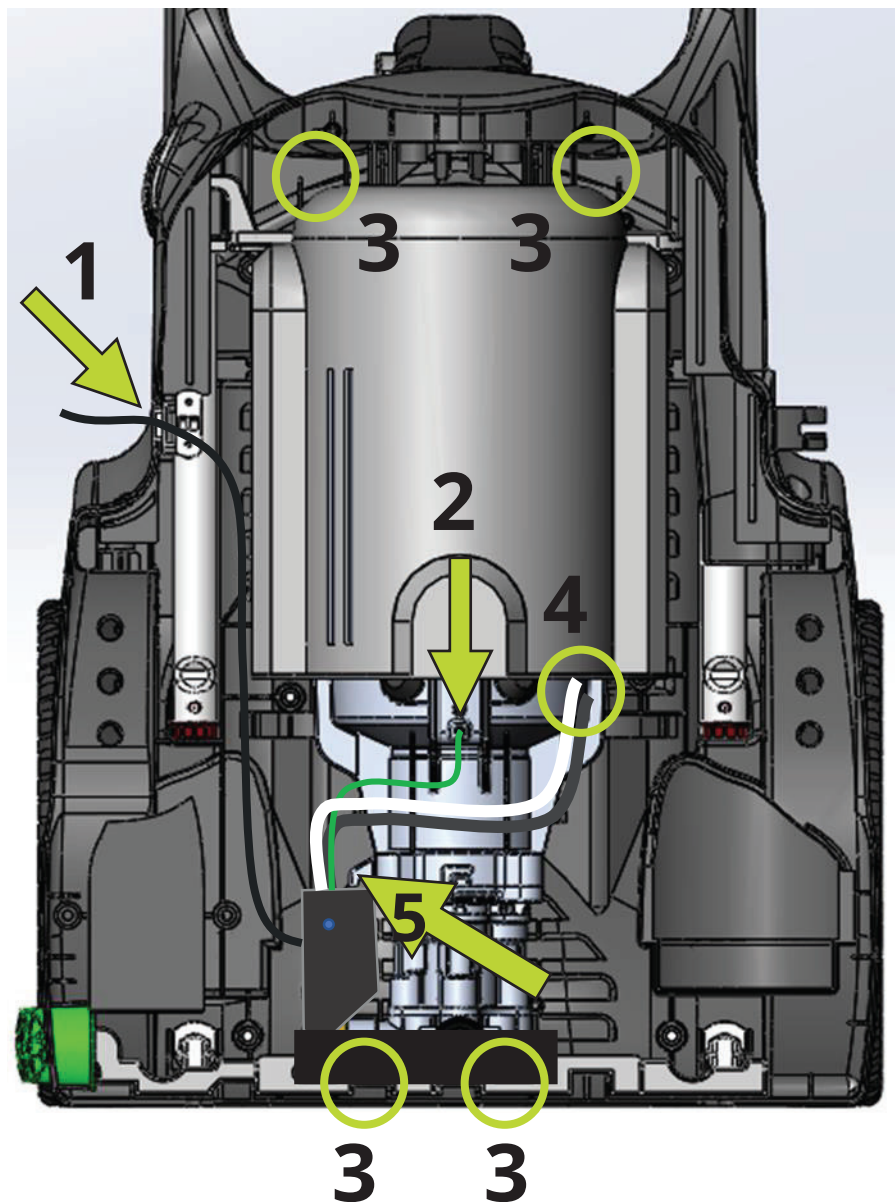

You must loosen the motor and pump to be able to turn off the electric box:

- 1) Unplug the power cord by pulling it straight up from the cover. It is not necessary to unscrew.
- 2) Unscrew the grounding from the motor (Phillips screw).
- 3) Motor and pump are attached in 4 places, 2 screws on the motor cover and 2 screws on the pump cover. Loosen all four screws.
- 4) Route the cables that go to the motor. They are joined with shovel connectors. Redeem these.
- 5) Turn the motor 180 ° to get to the screw that holds the electrical box. It is not necessary to disconnect the high pressure hose.

4

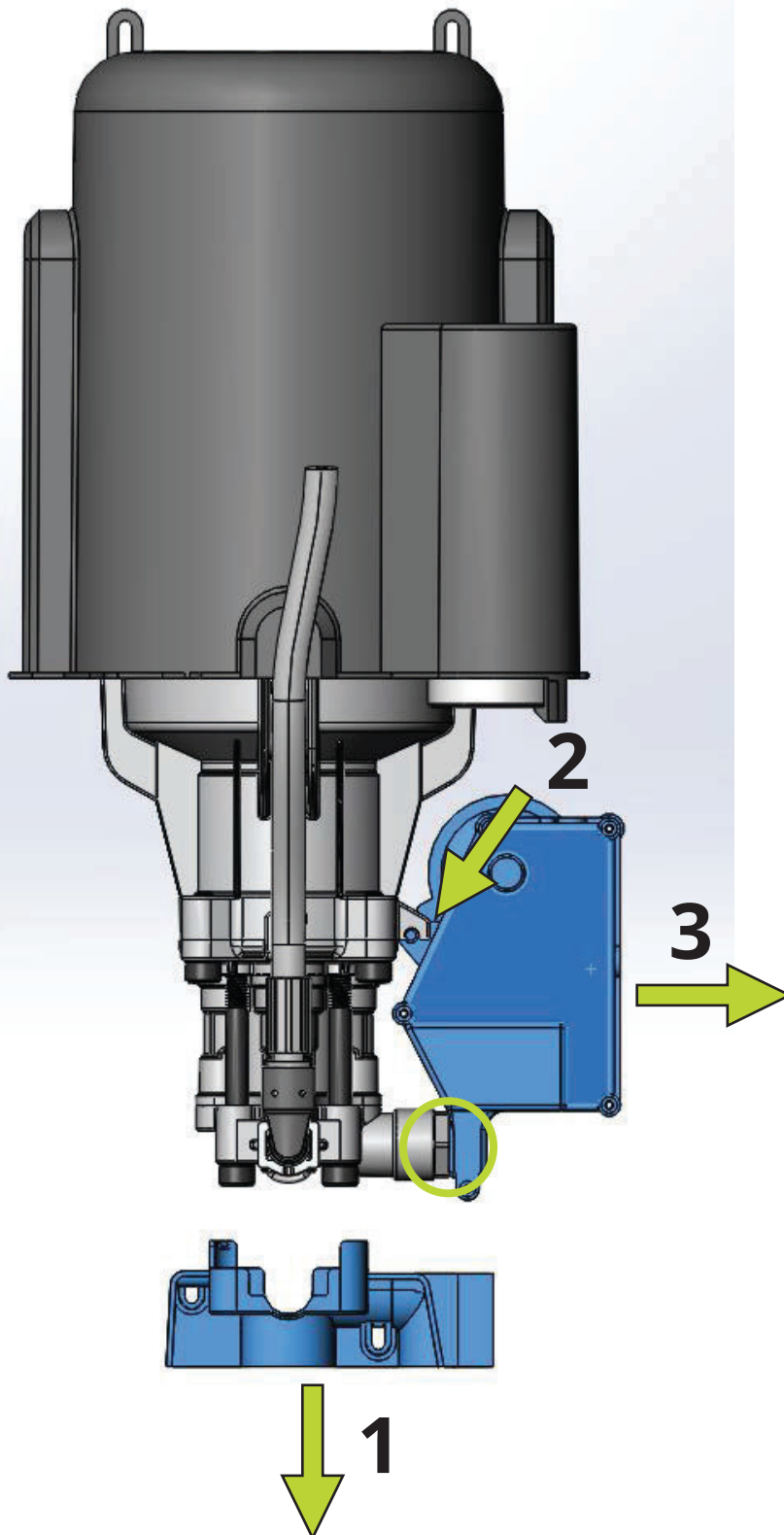

1) Release the plastic cover located on the pump. It is attached with two plastic clips that sit diagonally opposite each other

2) Unscrew the screw that holds the power box.

3) Grasp the upper part of the power box and pull. The box should detach from the pressure switch (in the circle) with a pop

NOTE !!

In this chapter we explain how to change the microswitch inside the electrical box. If you only need to change the entire electrical box, you can skip this and scroll on to the chapter:Step 11

5

!!! Disconnect all power before you start working with the electrical box !!!

The microswitch to be replaced is located inside this box. To access, use a Phillips screwdriver and unscrew the 5 screws (indicated by a circle)

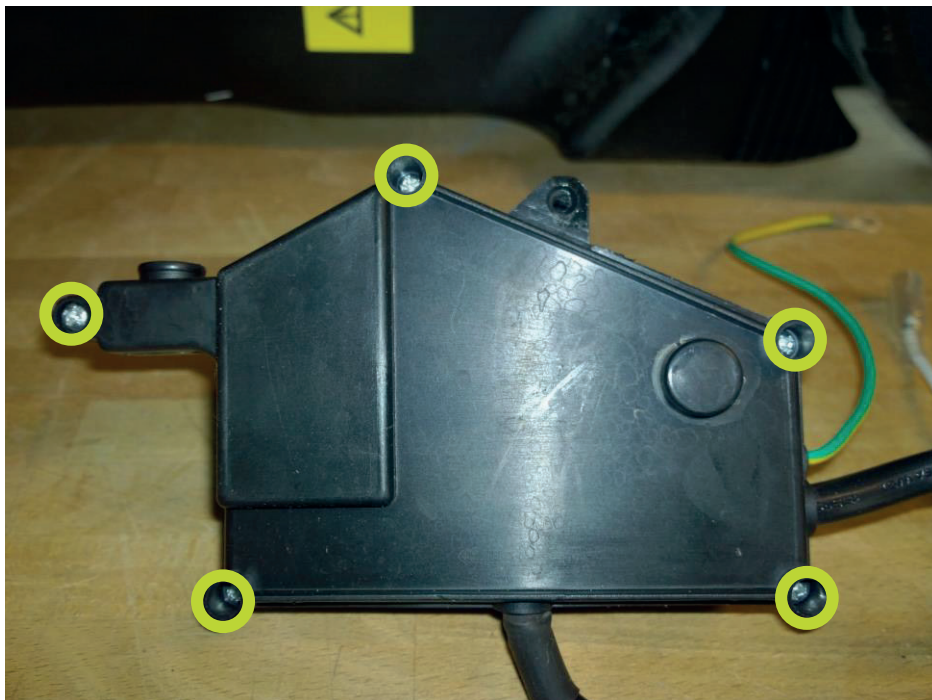

When the screws are out, you can lift off the cover that gives access to the various switches in the electrical box.

Take care of the o-ring and the red slide.

You can now lift out the pressure switch 1 and the main current switch 2.

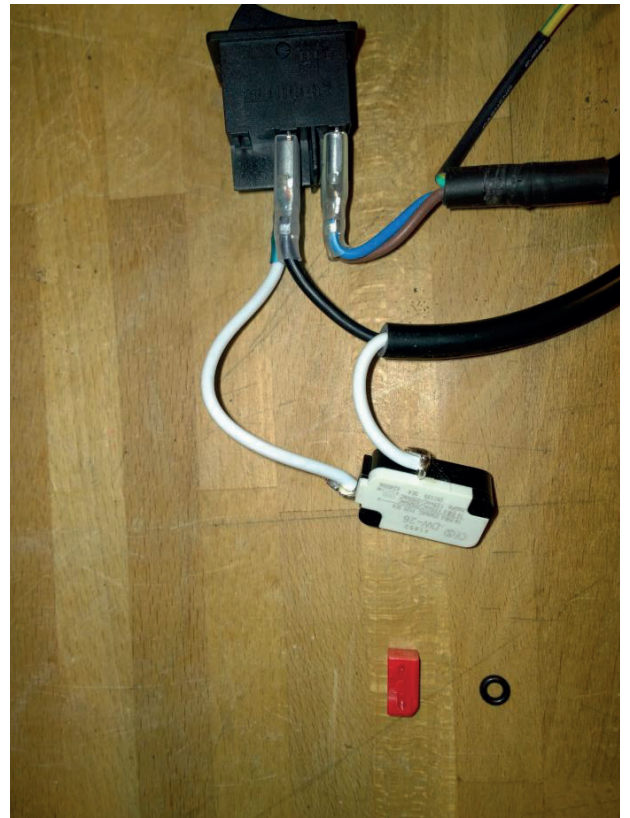
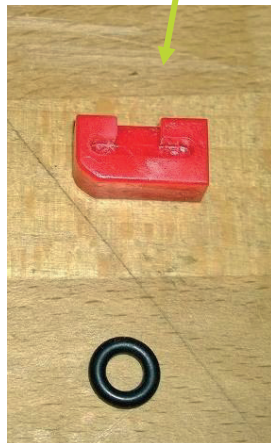
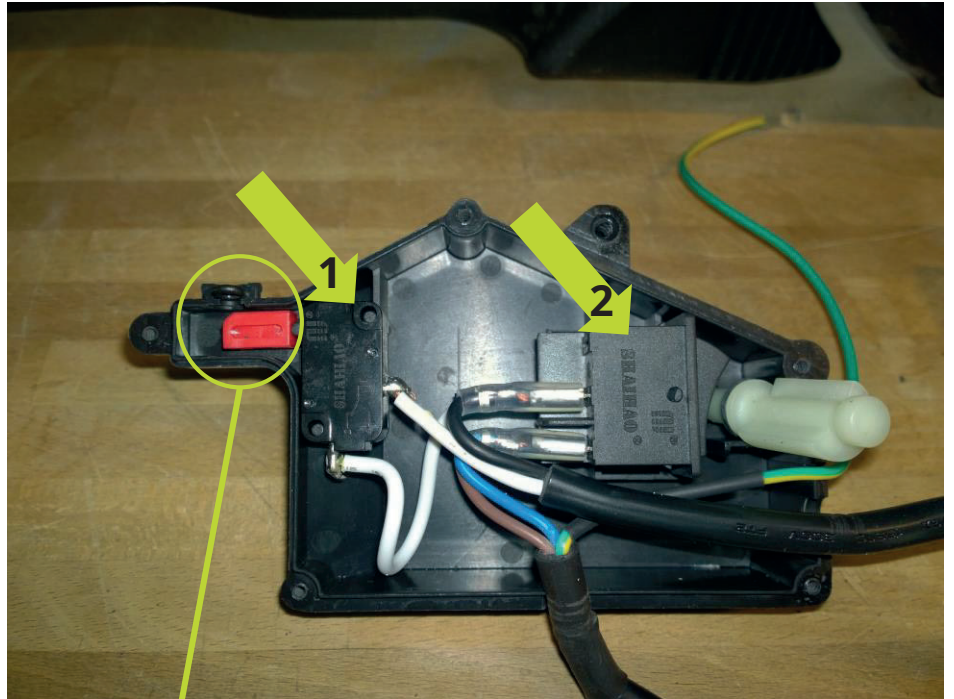

7

The microswitch you need to replace is attached to the main switch with 2 spade switches. These have a small security lock to prevent that they fall off. Push down the small metal arm (1) and pull the cord off.

The microswitch is now loose and can be replaced with a new switch. Push both shovel connectors into place on the main switch and gently pull them to check that they are secure.

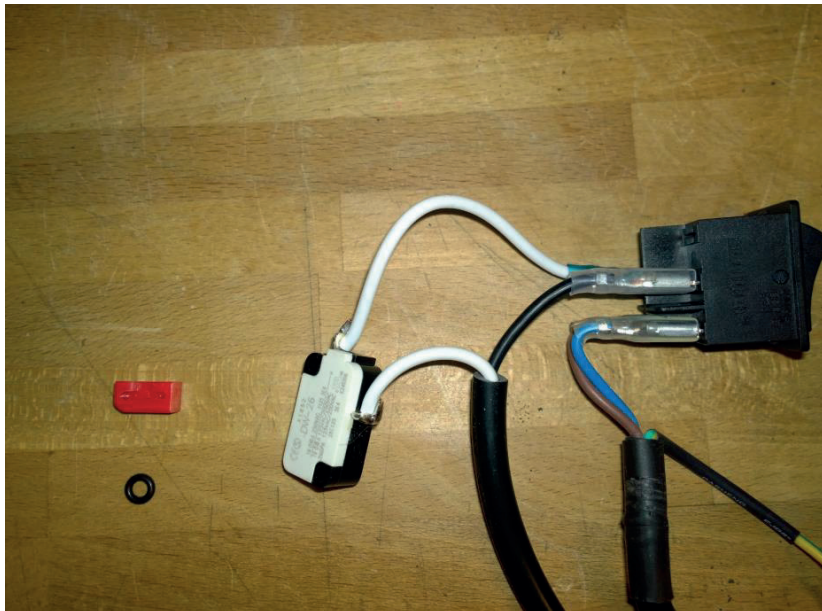
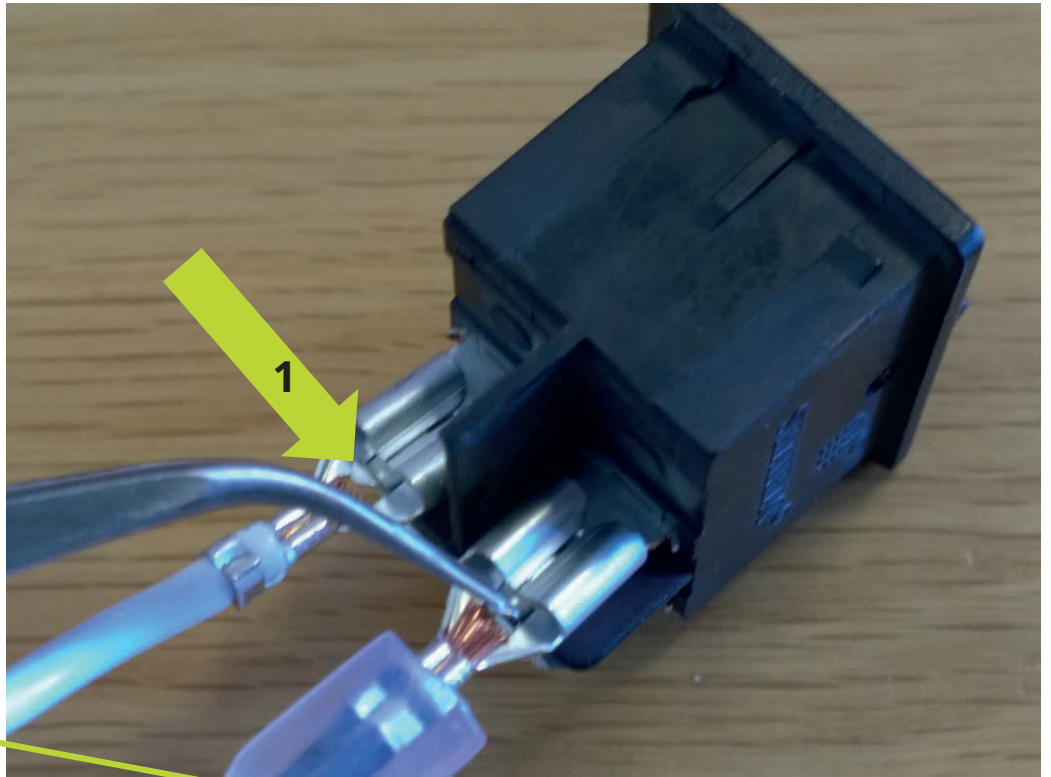

The switches are now ready to be mounted in the electrical box again.

Both switches are put back in the same position as when they were removed. They will only fit in one way, so it's hard to make a mistake here. Check that the white shaft (1) is in the correct position. (same as picture)

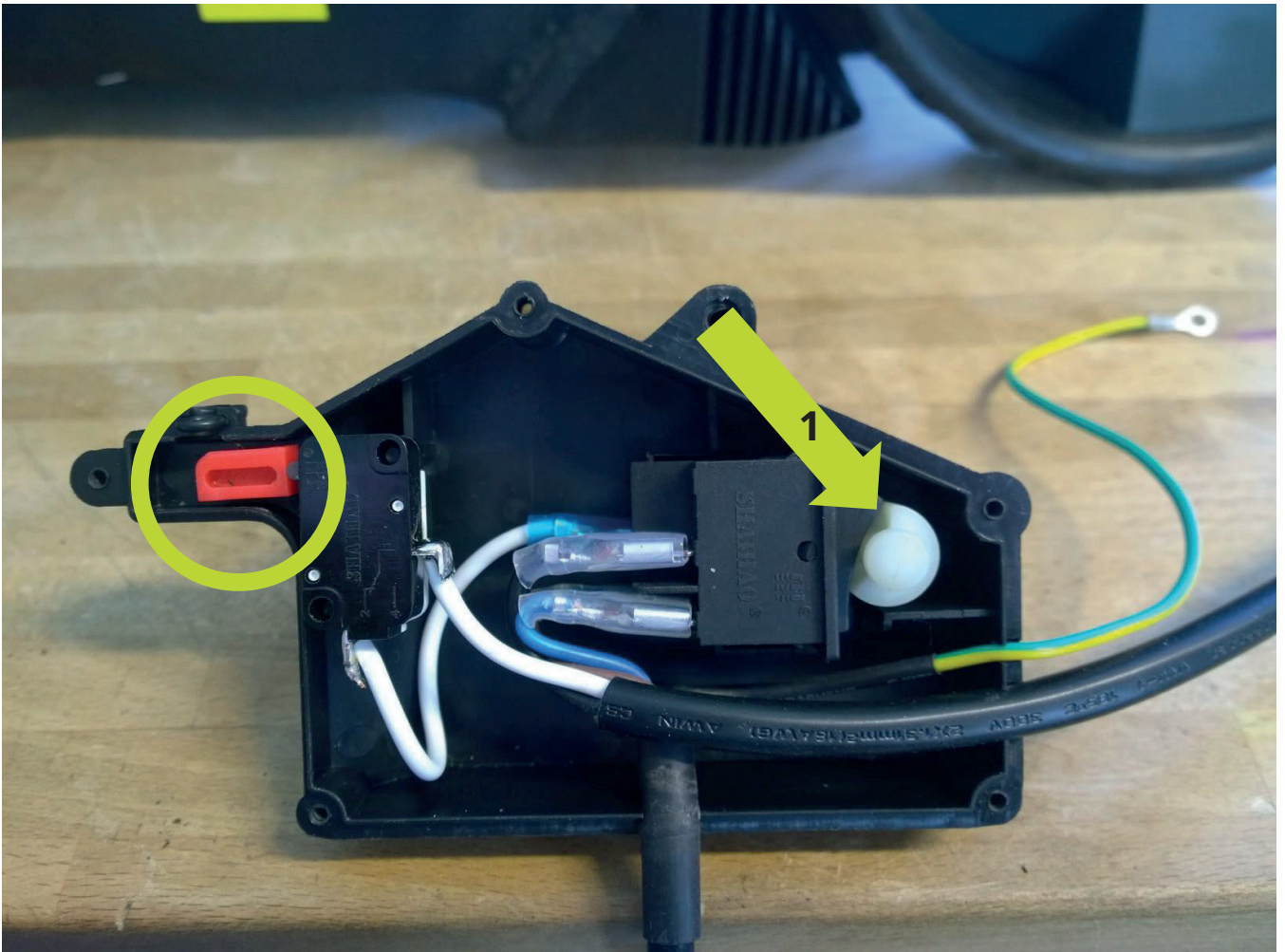

Then saw the cables out of the holes in the electrical box. Main power cable goes straight down. Secondary current and earth cable must be in the holes on the right side As shown in the picture.

Finally, put the o-ring and the red slide in place. Make sure that the slide moves freely and that it activates the microswitch.

Last but not least, put the lid on and tighten the screws carefully.

With the lid and screws in place, check that the white shaft (1) operates normally by turning it clockwise and counterclockwise. This should activate the main switch and you should hear a click.

Use a small screwdriver / string or similar to check that the red slide operates by pushing lightly in the direction of the arrow (2). Here, too, you will hear a small click when the switch is activated.

If everything is in order, you are now ready to mount the electrical box to the pump.

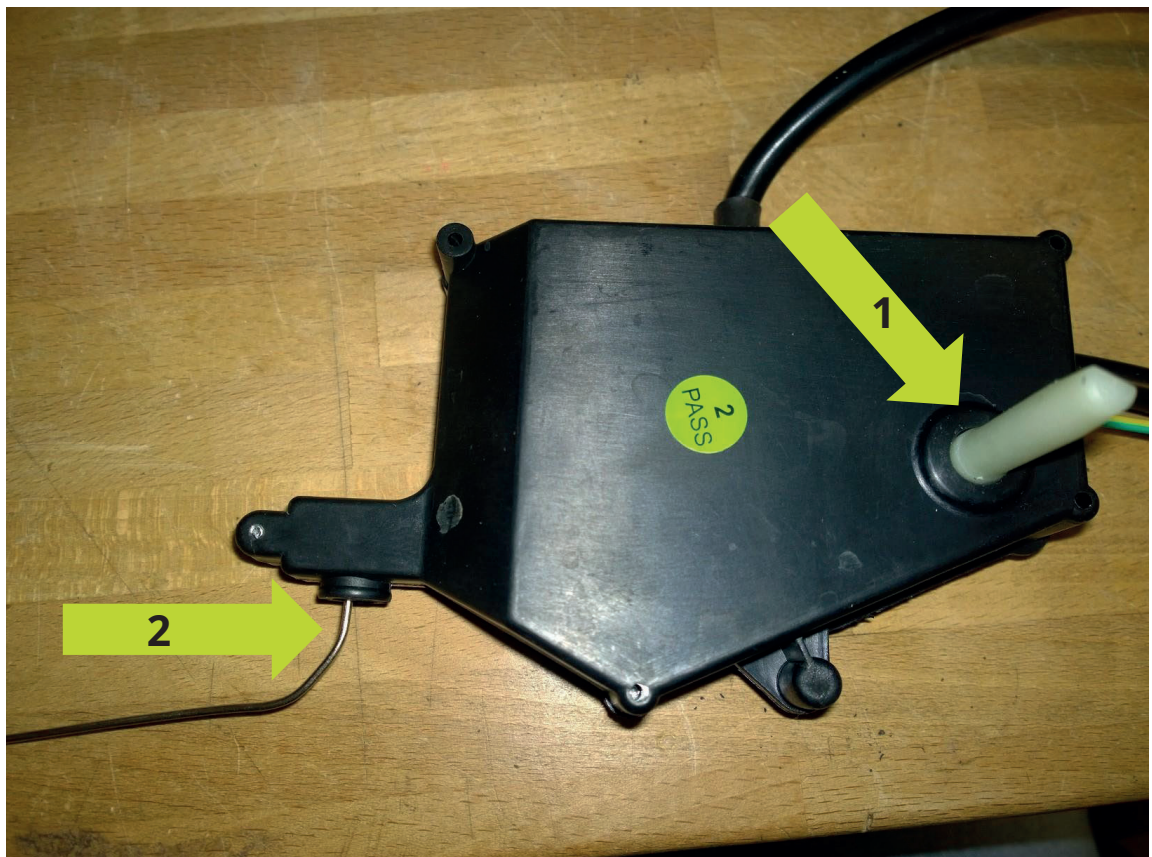

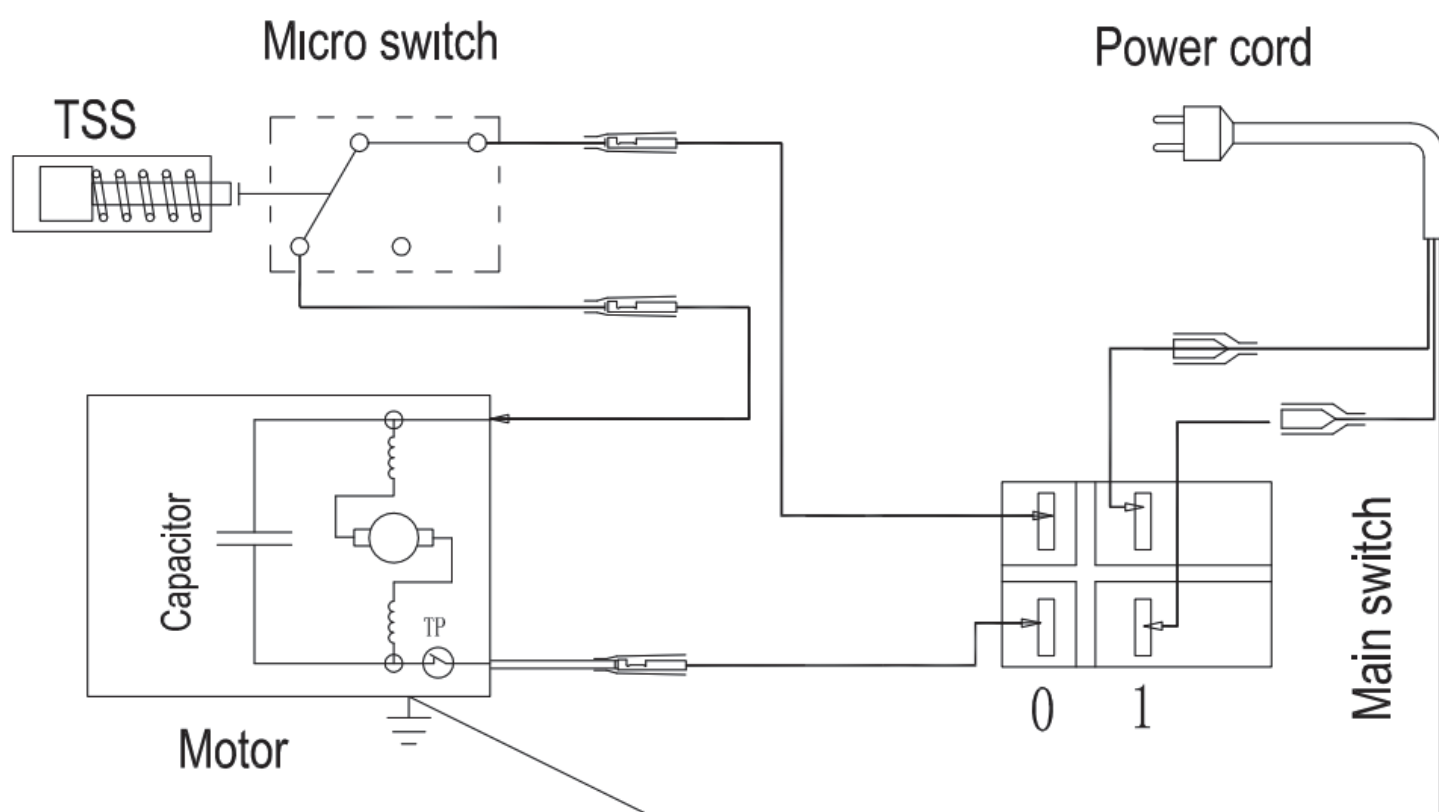
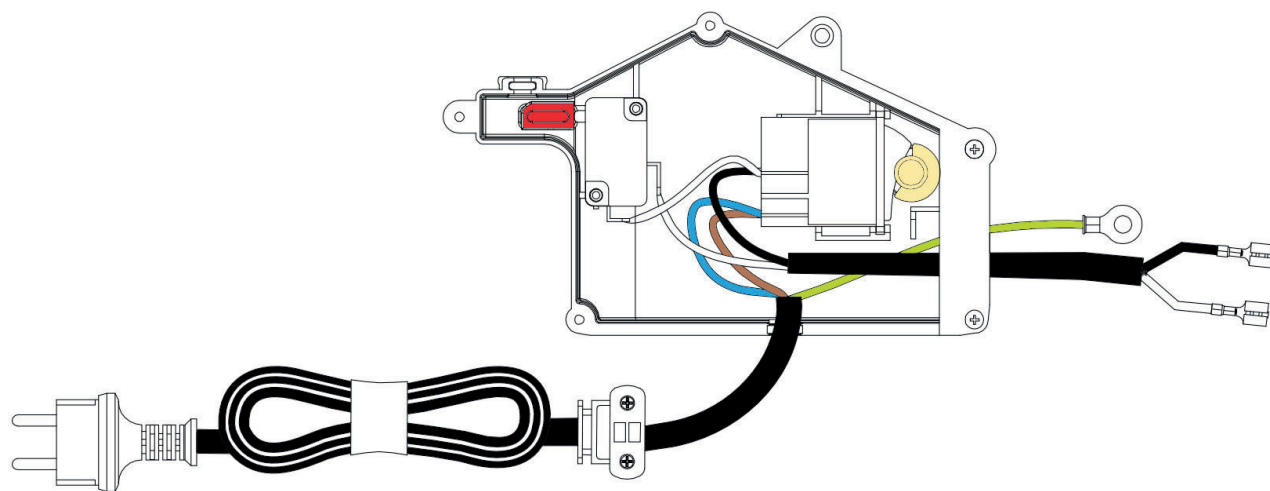

Circuit diagram

11

1) Press the electrical box hard against the pressure switch. It should come into place with a click.

2) Tighten the screws that secure the electrical box.

3) Click on the plastic cover on the pump.

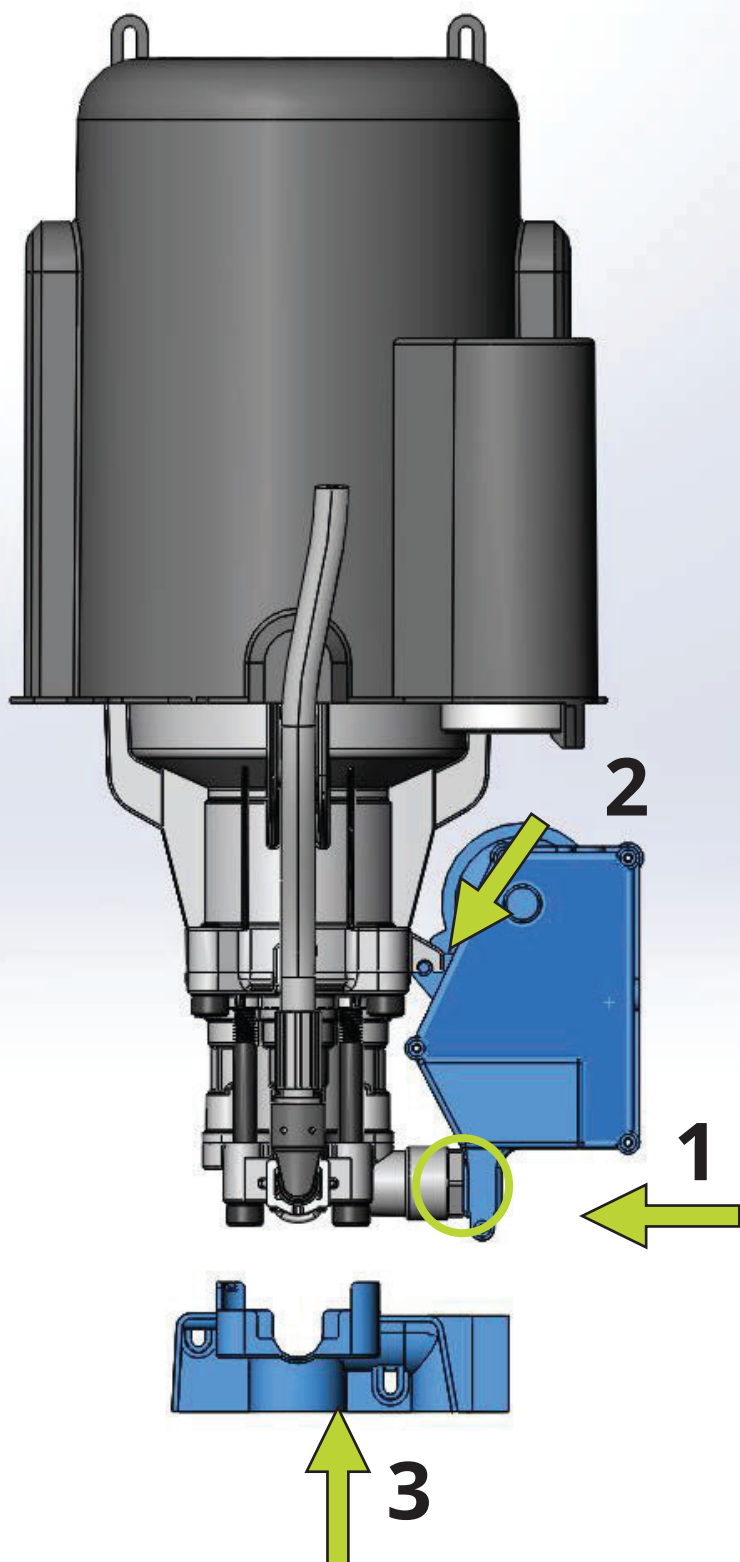

Turn the engine 180 ° back as it was. Check that the high pressure hose on the back is ready for the engine. It should be in a small track.

- 1) Press in place the power cord holder here.
 - 2) Screw the grounding from the motor to the electrical box (star screw).
 - 3) Connect the cables from electrical boxes to the corresponding cables from the motor. Push these into place under the engine cover.
 - 4) If the motor is positioned correctly, the holes in the cover must correspond to the holes in the motor and pump cover. If not, lift the engine and check for foreign objects under it.
- Tighten all four screws.

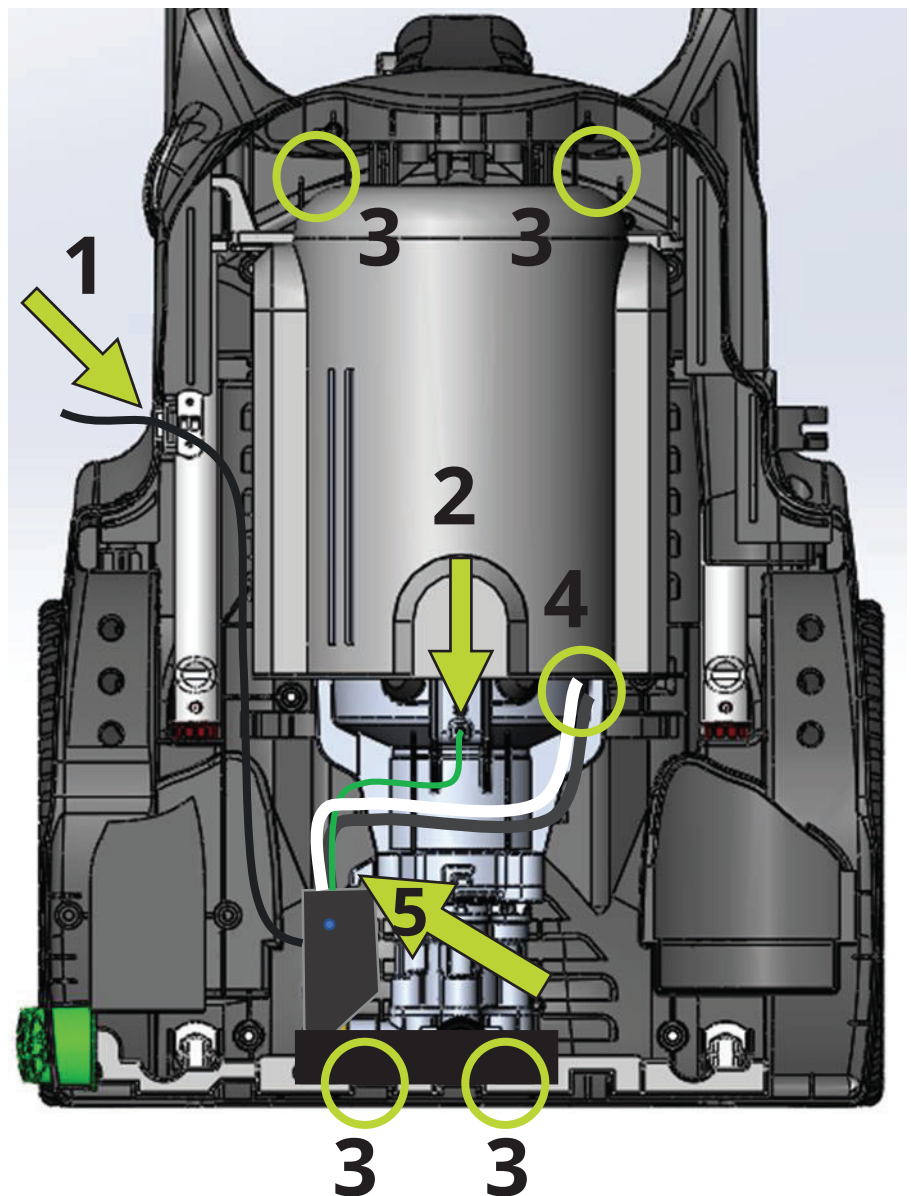

- To be able to replace the cover (Blue), you must press the footrest release button (1) so that the footrest (Green) can be pushed into place.
- Once you have the footrest and the locking rail in place, you can start putting on the cover.
- Make sure that all support structures and lips on the foot cover end up on the inside before screwing the machine back together. It may take some effort to achieve this.

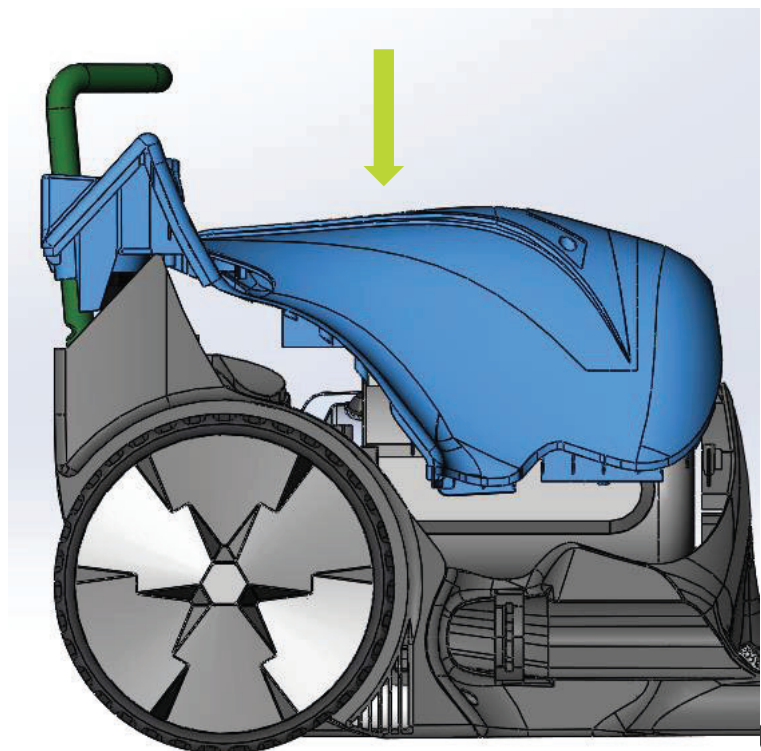
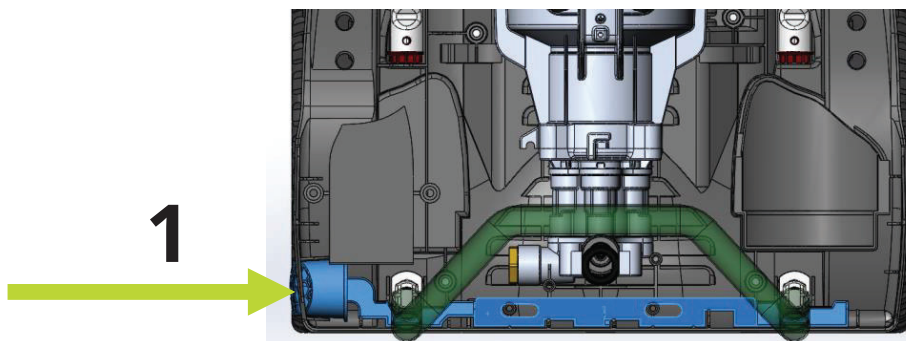

Raise the machine.

Fasten the six screws you removed in the first step. It is easiest to start with the screws at the bottom. Then the top ones and finally the ones in the middle.

Make sure that all the lips and support structures on the front cover are in the correct position as you screw in the screws.

Do not overtighten the screws, they are threaded in plastic.

The machine should now be ready for use.

